

# HARDWARE

## Local time unit - L.T.U.

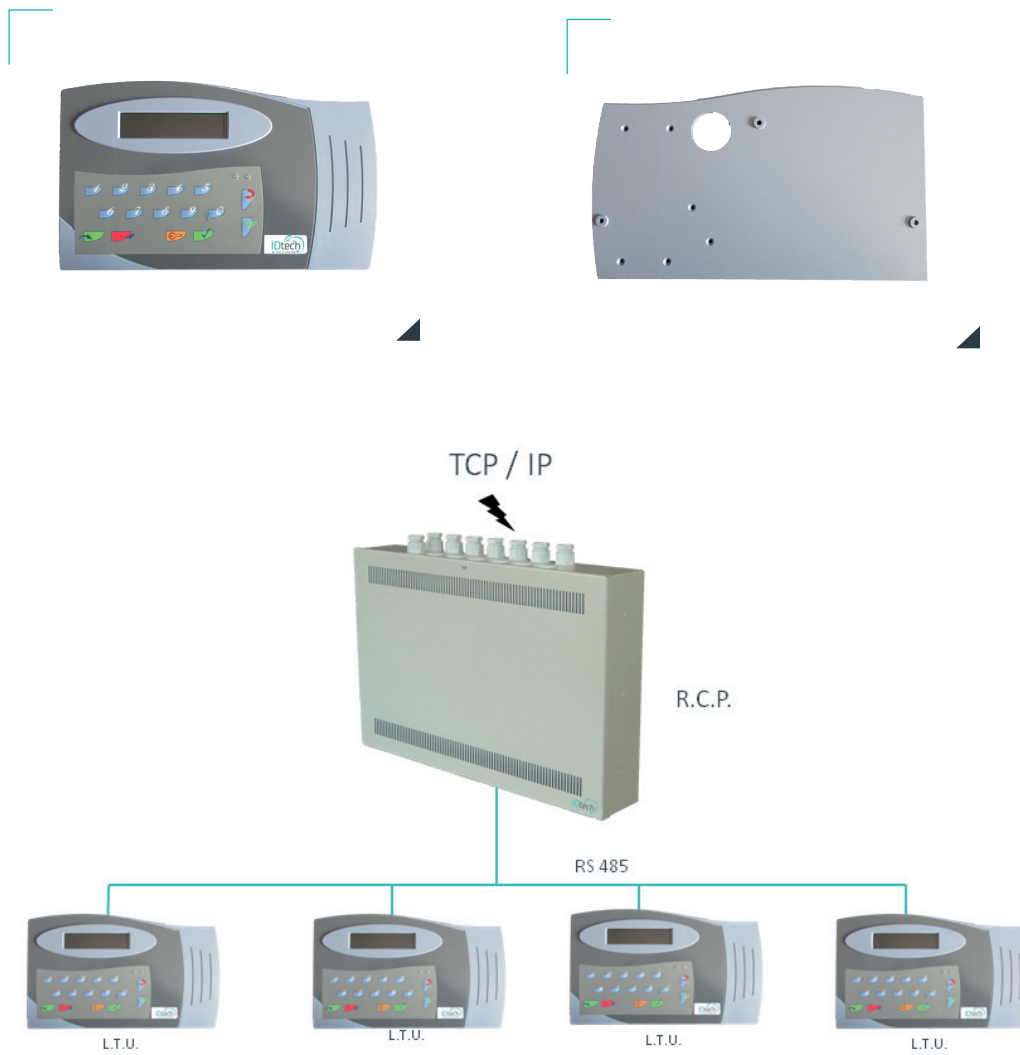

The local time unit (L.T.U.) is a timeclock terminal specially designed for entering working hours. The L.T.U. must be connected to an intelligent controller (R.C.P./xx).

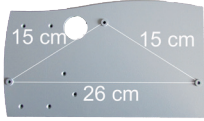

## SPECIFICATIONS

Available options	Outdoor version
Output voltage	12 VDC
Typical power consumption	0,35 mA (excluding peripherals)
Connections with the controller	RS 485 with R.C.P./b4, b10 and R.C.U./b10 and R.C.P./m8
Keypad	16 keys
User interface	<ul style="list-style-type: none"> <li>• LCD 2 lines of 16 characters</li> <li>• Backlight</li> <li>• Beeper</li> <li>• 4 LEDs</li> </ul>
Logical inputs	4 voltage-free inputs
Output relays	2 relay outputs NO, NC
Size	29,5 cm x 17,4 cm x 4,6 cm
Fixing points	
Mounting	Wall-mounting
Temperature	0°C....+ 60°C
Conformity	CE

## FEATURES

- Clock in and out
- Numeric codes (missions, ...) entry
- Query results for specific periods and counter values when connected to the controller
- When clocking in or out, balance can be displayed in real time when connected to the central server and real-time calculation mode is activated
- The last result is available in offline mode if connected to the controller

## CHARACTERISTICS

- Secure communication protocol
- Time registration data capture terminal with keypad & 2x16 character display
- Hardware operational control that reports any errors or technical faults to the central unit
- Compatible with a variety of identification technologies: magnetic, chip card, remote control, Mifare, Desfire, W26 bits, Magstripe, biometrics (iris, fingerprint, hand geometry)
- Fully integrated to the IDtech software suite
- 100% compatible with the controllers in the IDtech range
  - R.C.P./b4
  - R.C.P./m8
  - R.C.P./b10
- Simple and easy installation
  - Wall-mounted
  - Controller connection (RS485 bus)
  - Power supply required (12 V DC)
  - Connection to peripherals via removable connectors



Rue Saucin, 62  
5032 Isnes – BELGIUM

T +32 (0)81 55 46 10  
F +32 (0)81 55 97 69

Franklin Rooseveltlaan 349/B. 22  
9000 Gent – BELGIUM

T +32 (0)9 262 03 14  
F +32 (0)9 265 02 50